

**NOTES:**

**ELECTRICAL:**

1. VOLTAGE RATING: 125 VAC RMS.
2. CURRENT RATING: 1.5 AMP.
3. CONTACT RESISTANCE: 50 MILLIOHMS MAX.
4. INSULATION RESISTANCE: 1000 MEGOHMS MIN @ 500 VDC.
5. DIELECTRIC STRENGTH: 1000 VAC RMS 60Hz, 1MIN.

**MECHANICAL:**

1. HOUSING MATERIAL: GLASS FILLED NYLON UL94V-0.
2. INSERT MATERIAL: GLASS FILLED NYLON UL94V-0.
3. CONTACT MATERIAL: PHOSPHOR BRONZE t=0.35mm
4. CONNECT PLATING: SELECTIVE GOLD PLATING OVER NICKEL.
5. OPERATING LIFE: 750 CYCLES MIN.
6. PCB RETENTION PRE-SOLDER: 1 LB MIN.
7. PCB RETENTION POST-SOLDER: 10 LBS MIN.

**ENVIRONMENTAL:**

1. STORAGE: -40°C TO +85°C.
  2. OPERATION: -40°C TO +85°C.
  3. WAVE SOLDERING TEMPERATURE: 255~265° (5~10 SECONDS)
- MATES WITH MODULAR PLUG CONFORMING TO FCC PART 68, SUBPART F.

CUL FILE NO. E163191

PART NUMBER:	CONTACT GOLD PLATING
E5908-000343-L	15U"
E5908-000344-L	30U"

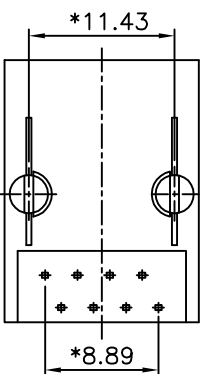
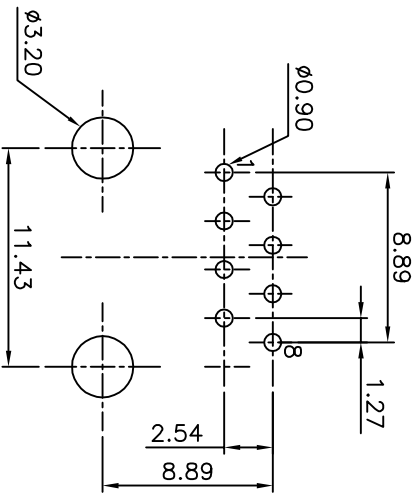

PC Board Layout  
Component Side Shown

DETACHED LISTS		TOLERANCES EXCEPT AS NOTED	
MM	(INCH)	MM	(INCH)
0 ± 0.2	±	±	±
.00 ± 0.15	±	±	±
.000 ± 0.075	±	±	±
ANGLES ± 0.5			
THIRD ANGLE PROJECTION			
RoHS Compliant		Pulse A TECHNOLOGI COMPANY	
TITLE		20.57 PCB JACK 10P	
DRW DZHD	DRAWING NO. CE593092-1A	DATE 04/17/07	/PART NO. SEE NOTE
SCALE : 2.5:1	DO NOT SCALE DRAWING	SHEET 1	OF 1

8 7 6 5 4 3 2 1